

EXOCET ESSENTIAL

THE ESSENTIALS FOR NAVIGATION, DATA MANAGEMENT, AUTOPILOT AND SAFETY

Exocet Essential is an all-in-one unit for navigation, data, autopilot, and safety. Standardized, simple, and effective, it adapts to most projects. Integrating algorithms proven in IMOCA and Ultim campaigns, it makes offshore racing technology accessible to all. The 2025 version delivers enhanced safety with advanced Man Overboard functionality, optimized performance, and new graph-based analysis tools.

MAIN FEATURES

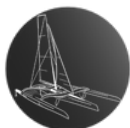

**ADVANCED CALCULATION
OF TRUE WIND AND
LEEWAY**



**NAVIGATION
DATA DISPLAY**



**AUTOMATIC SENSOR
FAILURE MANAGEMENT**



**COLLECTION, PROCESSING
AND RE-EMISSION OF
NAVIGATION DATA**



**ALERTS
SYSTEM**



**NAVIGATION DATA
RECORDING AT 1Hz**



**MAN OVERBOARD
MANAGEMENT**



**AUTOPILOT PERFORMANCE &
SAFETY OVERLAYS**



EXOCET ESSENTIAL

14 590 € ex. VAT

An EXOCET Essential provided with:

- Two connection cables: CAN + CAN Ethernet
- Installation guide
- 2 hours of remote support during the first year

Exocet Essential Pack Buzzer option



- Exocet Essential
- Exocet Buzzer
- ExoConnect Analog
- Exocet Bracket
- Exocet Essential keyboard 6-keys
- 1 day engineer on board for commissioning and sea trials

15 990 € ex. VAT

Exocet Essential Pack Voice option



- Exocet Essential
- Exocet Voice (to be compatible in 2026)
- ExoConnect Analog
- Exocet Bracket
- Exocet Essential keyboard 6-key
- 1 day engineer on board for commissioning and sea trials

16 990 € ex. VAT

HOW IT WORKS?

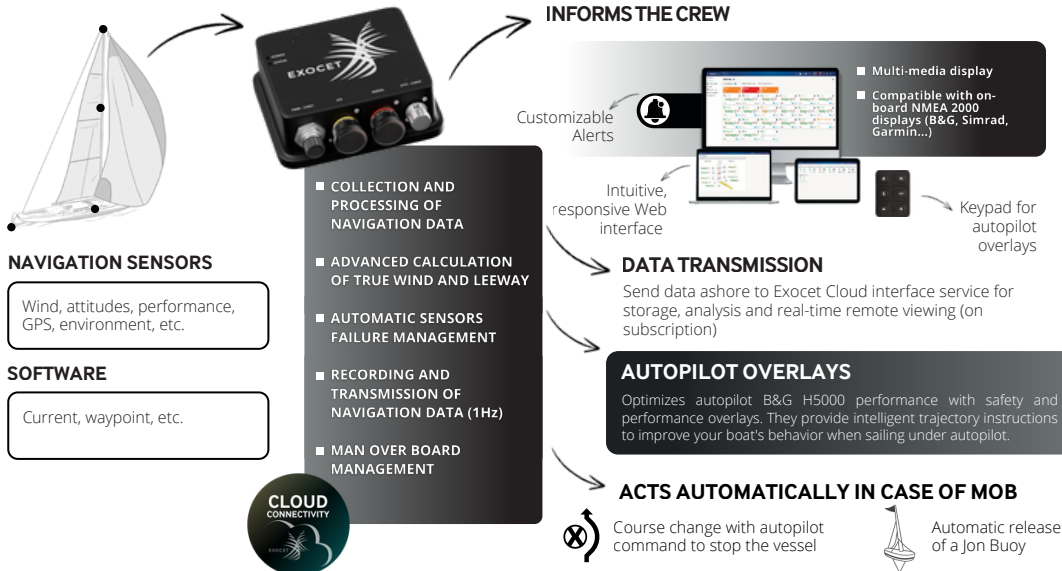

WHY CHOOSE EXOCET ESSENTIAL ?

- ✓ 3-in-1 product: high-performance sailing processor, data management and autopilot
- ✓ Automated sensor failure management: in the event of a sensor failure, the Exocet Essential automatically switches to another sensor
- ✓ Accurate and responsive true wind calculation, including boat leeway estimation
- ✓ Scalability: system designed to receive software updates to integrate new features
- ✓ Broad compatibility for optimal integration and connectivity
- ✓ Stand-alone installation possible

SPECIFICATIONS

PHYSICAL AND ENVIRONMENTAL

- Weight: 350 g
- Size: L113 x H97 x P40mm
- Materials: Anodized aluminum
- Operating temperature: -10°C / +50°C
- Water resistance: IP67
- Input voltage: 9 - 51V
- Power consumption: 4W
- Certifications: CE EN 60945 and FCC

INPUT/OUTPUT INTERFACES

- 1x Ethernet
- 2x CAN 2.0
- 6x Analog inputs - 16 bits 50 Hz
- 2x Digital contact inputs
- 3x Digital contact outputs
- 5x RS232 serial
- 1x RS232 / RS422 serial

APPLICATIONS

- **NAVIGATE EFFICIENTLY** using reliable indicators such as true wind and vessel performance.
- **TAKE ADVANTAGE OF A READY TO USE SOLUTION** designed to meet the essential needs of competitive sailors.
- **OPTIMIZE YOUR AUTOMATIC PILOT** with a faster, safer trajectory.
- **ANALYZE YOUR EXPLOITS** by recording precise navigation data to evaluate and improve your performance.
- **NAVIGATE SERENELY** by receiving customizable alerts for any sensor failure or weather change.